

## DM SILVER

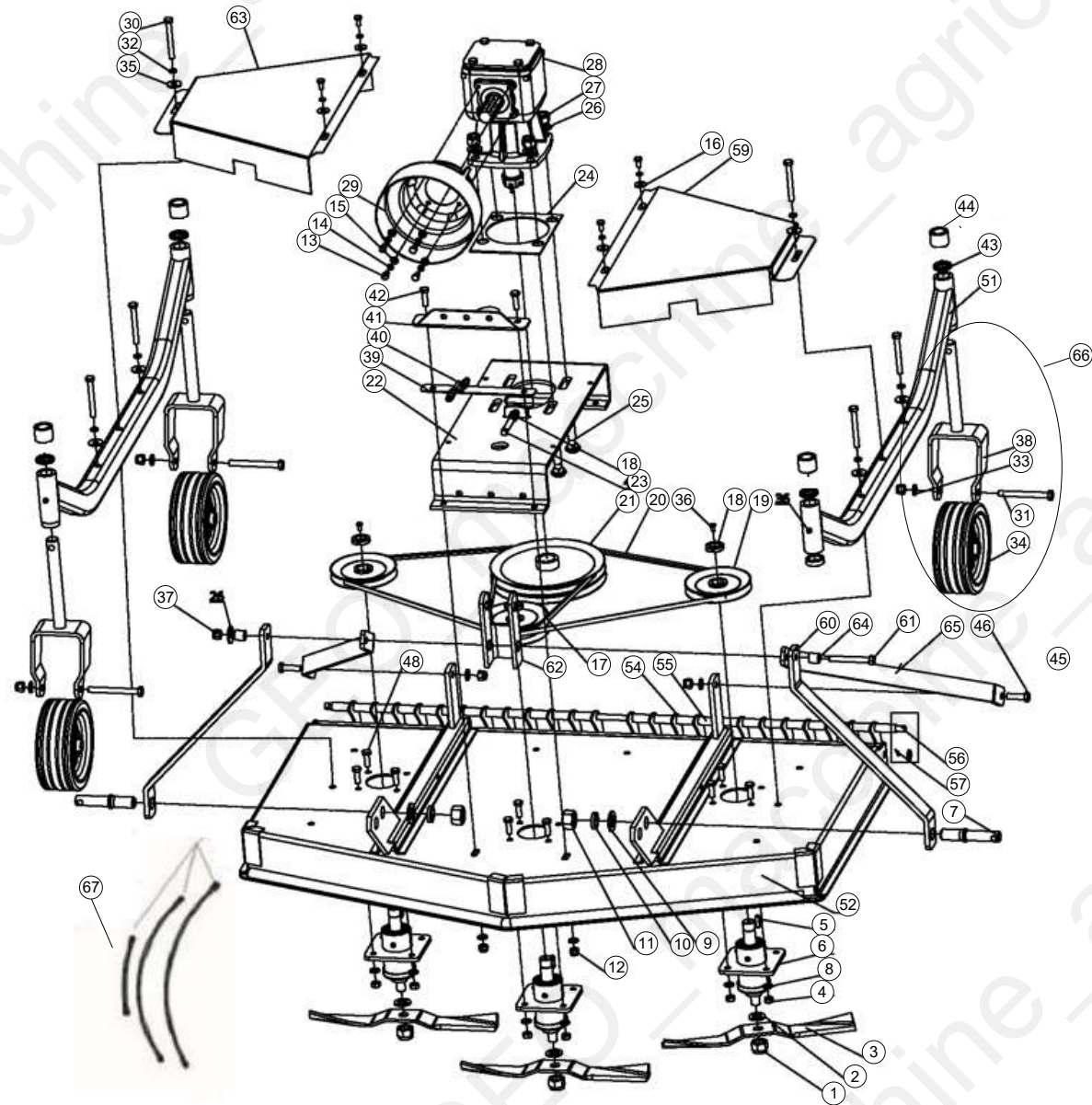

# Table of Contents

Tavola	Page
Dmsilver_parte 1	3



Pos	Code	Description	NOTE	Q.
1	GB889-86-M18x1.5	Lock Nut M18*1.5		3
2	GB.858-85	Washer		3
3	DMS.120.00.118	Blade (L1=410) -Tipo2		3
3	DMS.150.00.118	Blade (L1=510) -Tipo2		3
3	DMS.180.00.118	Blade (L1=610) -Tipo2		3
4	GB6170-M10	Nut 10		12
5	GB.1096-86-8x30	Key 8*30		3
6	FMN120.00.012	Bearing Seat Assemblt DMS		3
7	SL140.00.109	Bolt Lower Pin		2
8	GB97.1-10	PLAIN WASHER 10		14
9	GB97.1-24	Plain washer 24		2
10	GB93-24	spring washer 24		2
11	GB6170-M24	Nut 24		2
12	DMS.120.00.012	Spacer		9
13	GB5783-M8X16	bolt M8X16		8
14	GB93-8	Spring washer 8		8
15	GB97.1-8	Plain washer 8		26
16	GB96.1-8	Plain washer8		4
17	DMS.120.110.017	Pulley double Groove 110 diam		1
17	DMS.120.140.017	Pulley double Groove 140diam		1
18	DIN985	Lock Nut		3
19	DMS.120.110.019	Pulley single Groove 110 diam		2
19	DMS.120.140.019	Pulley single Groove 140diam		1
20	DMS.120.00.020	V-Belt Dmsilver 120 (17x1372)		2
20	DMS.150.00.020	V-Belt Dmsilver 150 (17x1600)		2

Pos	Code	Description	NOTE	Q.
20	DMS.180.00.020	V-Belt Dmsilver 180 (17x1905)		2
21	DMS.120.200.021	Pulley big double groove 200diam		1
21	DMS.120.230.021	Pulley big double groove 230diam		0
21	DMS.120.245.021	Pulley big double groove 245diam		0
22	DMS.120.00.022	Support DMsilver 120		1
22	DMS.150.00.022	Support DMsilver 150		1
22	DMS.180.00.022	Support DMsilver 180		1
23	GB.5782-86-M10x80	Ajusting Bolt M10*80		1
24	DMS.120.00.024	Sliding Plate		1
25	GB.93-87-16	Washer 16		4
26	GB/T93-16	Lock Washer 16		4
27	DIN985-M16	Locking Nut M16		4
28	XH30.283Z.01L	FM-FMS-30HP JCTT Gearbox		1
29	EF100.00.112	Guard Shade		1
30	GB5782-M10X90	Bolt M10x90		6
31	DMS.120.00.031	Spacer		8
32	GB93-10	spring washer 10		6
33	DMS.120.00.033	Plastic Spacer		8
34	DMS.120.00.034	Wheel		2
35	GB96.1-10	Plain washer 10		6
36	GB5783-M6X12	bolt M6X12		3
37	GB889-86-M12	Locking nut M12		13
38	DMS.120.00.038	Fork		4
39	FMN120.00.108	Tampone di gomma		2
40	FMN120.00.051	Gruppo ugelli di riempimento		1

Pos	Code	Description	NOTE	Q.
41	FMN120.00.107	Piastra di fissaggio ugello		1
42	GB5783-M10X35	Bolt M10X35		2
43	DMS.1.043	Spacer		4
44	DMS.1.044	Spacer		4
45	DMS.1.045	Spacer		4
46	DMS.1.046	Bolt M12*40		12
48	DMS.1.048	Bolt M10*25		11
50	DMS.1.063	Pin(Upper Hitch)		1
51	DMS.1.051	Bin		3
52	DMS.120.00.052	Main Deck Dmsilver 120		1
52	DMS.150.00.052	Main Deck Dmsilver 150		1
52	DMS.180.00.052	Main Deck Dmsilver 180		1
54	DMS.1.054	Chain		35
55	FMN120.00.101	bush		26
56	DMS.1.056	Chain Shaft		1
57	GB91-2.5X12	Coppiglia		1
59	DMS.120.00.059	Pulley Cover Dmsilver120 R		2
59	DMS.150.00.059	Pulley Cover Dmsilver150 R		2
59	DMS.180.00.059	Pulley Cover Dmsilver180 R		2
60	DMS.1.060	Rod		2
61	GB.5782-86-M12x120	Bolt M12*120		1
62	DMS.1.062	Hitch		1
63	DMS.120.00.063	Pulley Cover Dmsilver120 L		1
63	DMS.150.00.063	Pulley Cover Dmsilver150 L		1
63	DMS.180.00.063	Pulley Cover Dmsilver180 L		1

Machine: DM SILVER

Assembly: Dmsilver\_parte 1



Pos	Code	Description	NOTE	Q.
64	DMS.1.064	Sleeve		1
65	DMS.1.065	Tie Rod		2
66	DMS.004.043	Wheel Assembly DmSilver		0
67	DMS.120.00.87	Greasing Pipe SET DM silver 120-150		1
67	DMS.120.00.88	Greasing Pipe SET DM silver 180		1